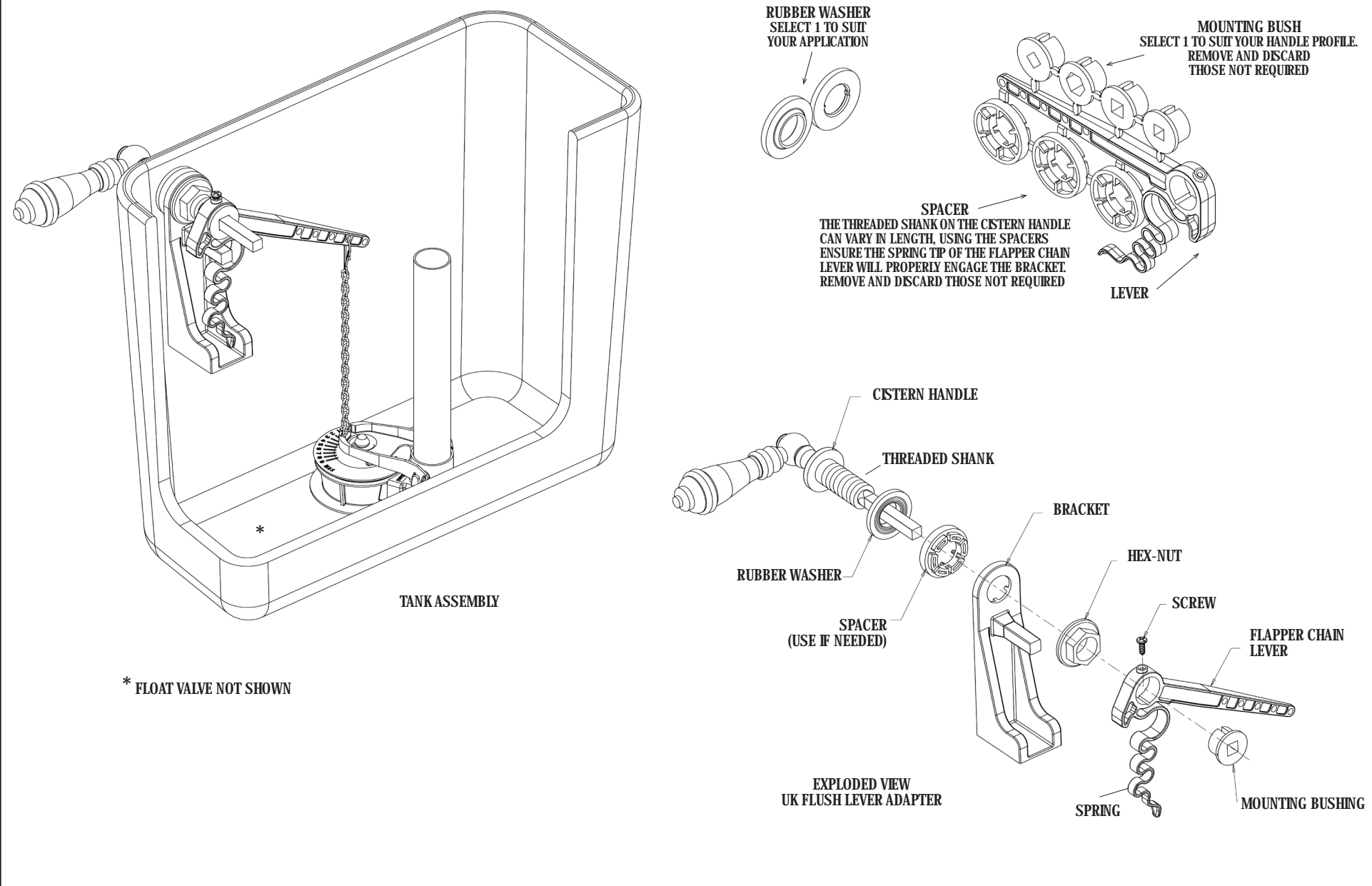

Diagram 2



FLUIDMASTER 400UKK077 FLOAT VALVE, FLUSH VALVE WITH FLAPPER AND HANDLE ADAPTER INSTALLATION INSTRUCTIONS

TO GET THE BEST RESULTS FROM YOUR FLUIDMASTER VALVE, PLEASE READ THESE INSTRUCTIONS CAREFULLY.

NOTE: SAVE INSTRUCTION SHEET FOR FUTURE REFERENCE CONCERNING THIS VALVE'S OPERATION AND MAINTENANCE.

WARNING: Fluidmaster shall not be responsible or liable for any failure of, or damage to, this plumbing product caused by its use in toilet cisterns containing high concentrations of chlorine or chlorine related products. Do not overtighten plastic nuts.

IMPORTANT: DO NOT use plumber's putty to seal this fitting.

Fluidmaster UK
 Twyford Road
 Rotherwas, Hereford, HR2 6JR
 Tel: 01432 357331
 Fax: 01432 264014
 E-MAIL: salesuk@fluidmaster.com
 WEB: www.fluidmasterUK.com

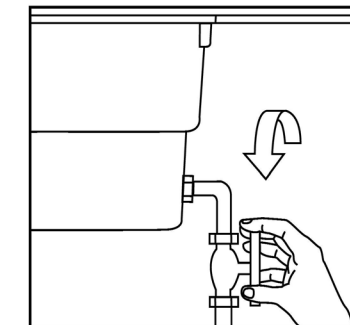
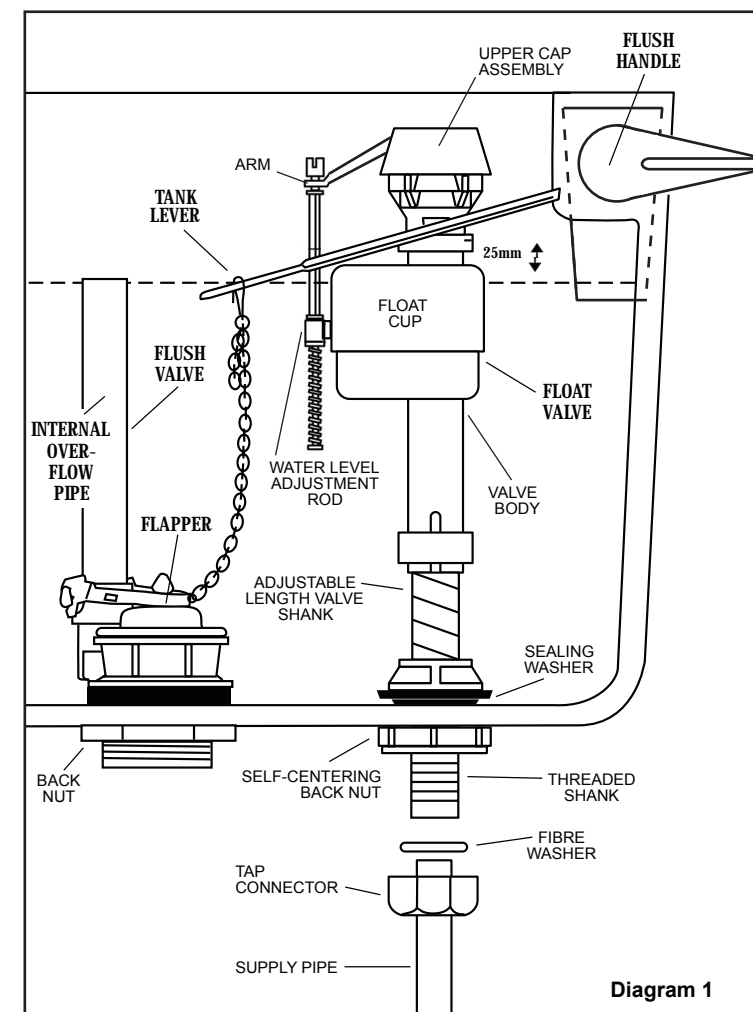

1. Turn off water supply to toilet cistern at storage tank in loft or isolator valve if mains fed.

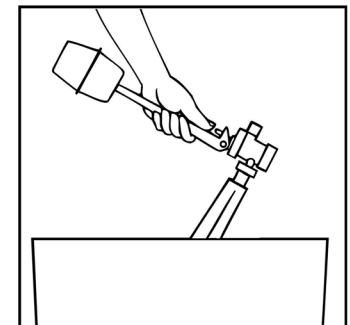

2. Disconnect pipe work and remove old float valve from toilet cistern.

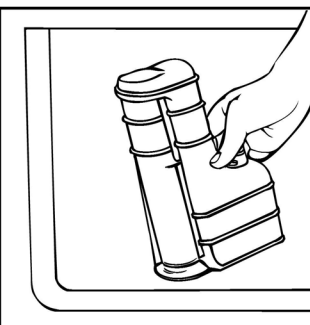

3. Disconnect pipe work and, if necessary, remove cistern from bowl. Remove old syphonic valve.

13. RE-FIT THE CISTERN HANDLE INTO THE CISTERN HOLE. THEN ASSEMBLE THE HANDLE ADAPTER INSIDE THE CISTERN, AS SHOWN IN DIAGRAM 2. ENSURING YOU SELECT THE CORRECT MOUNTING BUSH TO SUIT YOUR HANDLE PROFILE

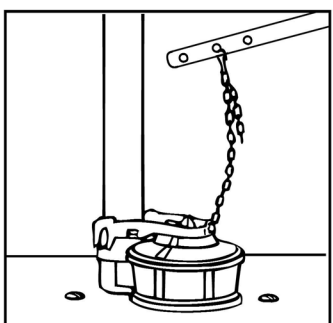

14. Attach flapper chain to lever hole directly above the flapper. Chain should have slight slack when flapper is in closed position. Cut excess chain. IMPORTANT: If chain is too tight, flapper will stay slightly open and leak. If the chain is too slack, it will not lift properly for a complete flush.

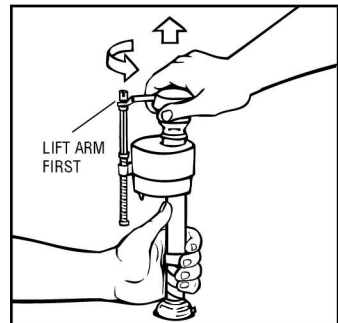

15. IMPORTANT: ALWAYS CLEAR DEBRIS FROM WATER LINE TO COMPLETE INSTALLATION. Before turning on water supply to cistern, remove VALVE TOP by lifting arm and rotating TOP 1/8 turn anti-clockwise, pressing down slightly on cap. While holding a container over the uncapped VALVE to prevent splashing, turn water supply on and off to clear debris that may be in supply line. Turn off water supply and replace TOP by engaging lugs and rotating 1/8 turn clockwise. MAKE CERTAIN TOP IS TURNED TO THE LOCKED POSITION. VALVE MAY NOT TURN ON IF TOP IS NOT FULLY TO THE LOCKED POSITION. Turn on water supply.

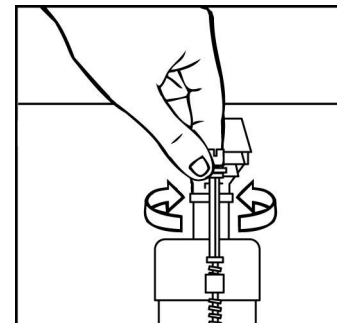
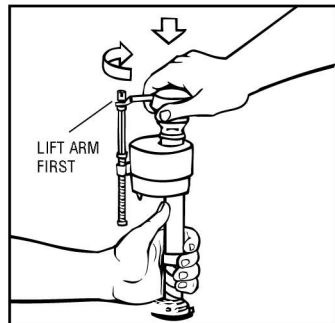
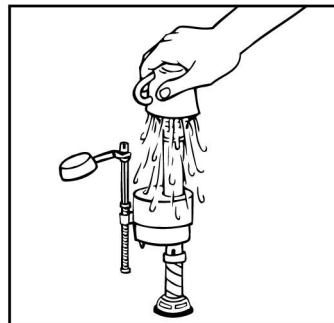

16. Adjust the water level by turning the water level adjustment rod and moving float cup up or down. Water level should be set to water line on cistern.

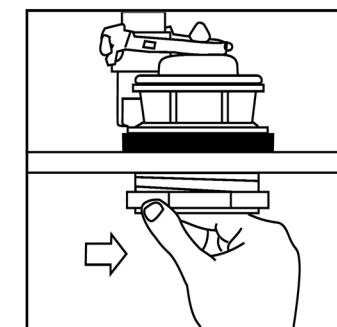

4. Slide new cistern seal onto threaded end of flush valve. Install new flush valve. Tighten back nut 1/2 turn beyond hand tight. DO NOT OVERTIGHTEN or cistern may crack.

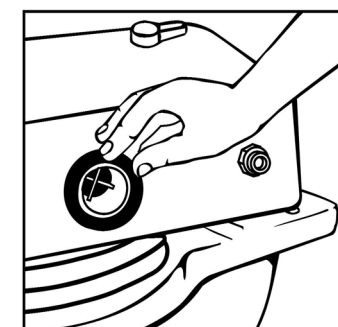

5. Carefully refit cistern-to-bowl seal (not supplied) onto threaded end of flush valve.

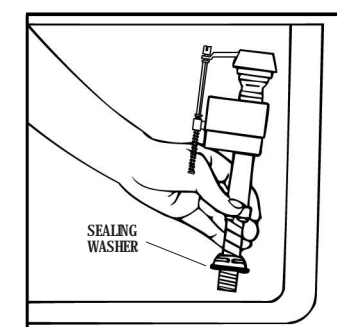

6. Place sealing washer on threaded shank of valve (cone facing down). Position valve in toilet cistern, passing threaded shank through hole in cistern to determine if valve height needs adjusting (see Step 7).

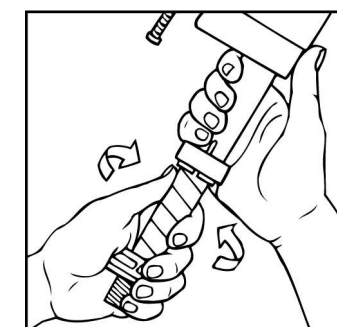

7. The Fluidmaster 400UK valve is adjustable in height from 225mm (9 inches) to 350mm (14 inches). To adjust height of valve, remove from toilet cistern and twist threaded shank in or out of valve body. A clicking noise will be heard on some models. This is normal. The valve height should be adjusted so that the critical level mark on the valve body is located at least 25mm (1 inch) above the overflow pipe in the cistern.

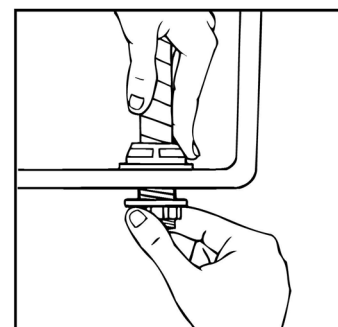

8. Install valve inside cistern. Start to thread back nut onto threaded shank so the shank protrudes through the cistern enough to enable tap connector to fit neatly. Do not tighten back nut at this stage.

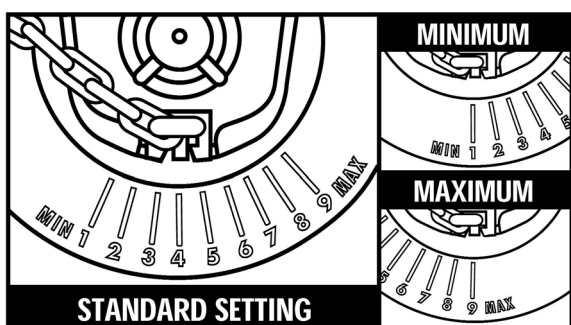

17. To adjust flush, begin where the chain attaches to frame as your centre point. Flapper is set at "9" for maximum flush volume. For standard flush volume, rotate flapper to "4". For less (minimum) flush, rotate flapper to "1." Or, rotate anywhere in between for the desired flush volume.

TROUBLESHOOTING - SEAL REPLACEMENT: If valve won't turn on or shut off or refill of cistern water is slow after valve has been in use for some time, a replacement seal may be needed. Ask your dealer for Model 242MP071 and install as follows:

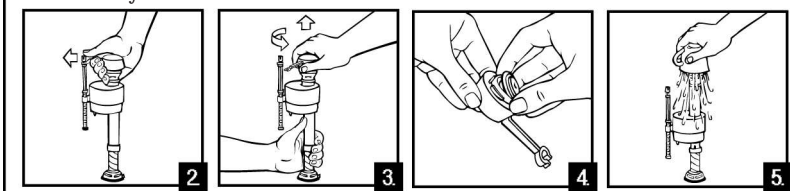

1. Turn off water supply in Figure 1 of instructions.
 2. Remove water level adjustment rod from upper cap assembly as shown.
 3. Remove upper cap assembly by lifting arm and rotating 1/8 anti-clockwise, pressing down slightly on cap.
 4. Replace seal.
 5. Hold a cup over the uncapped valve (to prevent splashing), and turn water supply on and off to clear debris in supply.
 6. Refit upper cap assembly. Make sure assembly is fully turned clockwise to the locked position or valve will not turn on. Reattach water level adjustment rod to upper assembly by snapping back in place.
 7. Turn on water supply as before.

GUARANTEE: This Fluidmaster product is guaranteed to be free from defective materials and workmanship for a period of one year. Units returned to Fluidmaster, USA, or CMI Distribution, UK will be replaced without charge.

Always use quality Fluidmaster repairparts when maintaining your Fluidmaster products. Fluidmaster shall not be responsible or liable for any damages caused by products used in Fluidmaster valves that were not manufactured by Fluidmaster, Inc.

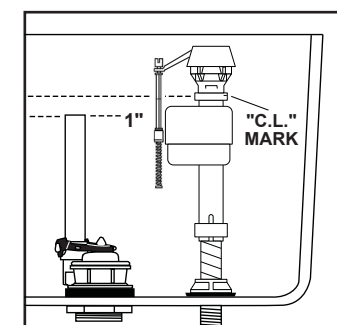

9. When installed, the top of the overflow pipe on the new flush valve should be at least 25mm (1 inch) below the hole in the cistern where the cistern lever is mounted. If necessary, cut the overflow pipe to achieve this height. The critical level mark on the float valve (identified by a C.L. mark on the Fluidmaster Float Valve) should be at least 25mm (1 inch) above the top of the over-flow pipe.

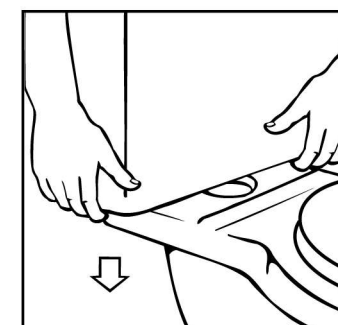

10. Reconnect cistern to pipe work or bowl.

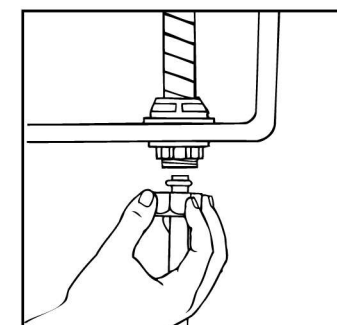

11. When position is correct and before tightening back nut of float valve, reconnect water supply to valve, making sure fibre washer is seated correctly. Tighten tap connector 1/4 turn past hand tight with spanner (DO NOT OVERTIGHTEN). Now tighten back nut with spanner 1/4 turn past hand tight (DO NOT OVERTIGHTEN).

CAUTION: Overtightening of back nut or tap connector could result in breakage and potential flooding.

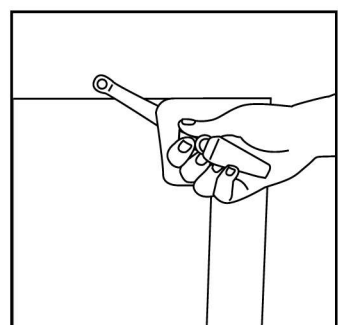

12. Unthread and remove cistern handle and syphon linkage.