

FLUIDMASTER® 507UKK073 / 074 / 075 FLUSH VALVE WITH FLAPPER AND FLUSH BUTTON INSTALLATION INSTRUCTIONS

TO GET THE BEST RESULTS FROM YOUR FLUIDMASTER VALVE, PLEASE READ THESE INSTRUCTIONS CAREFULLY.

THE VALVE SHALL BE INSTALLED WITH THE WATER LEVEL SET BELOW THE LOWEST PART OF THE INLET OR IN COMPLIANCE WITH THE WATER SUPPLY (WATER FITTINGS) REGULATIONS 1999 AS A TYPE AG OR AC AIR GAP.

NOTE: SAVE INSTRUCTION SHEET FOR FUTURE REFERENCE CONCERNING THIS VALVE'S OPERATION AND MAINTENANCE.

WARNING: Fluidmaster shall not be responsible or liable for any failure of, or damage to, this plumbing product caused by its use in toilet cisterns containing high concentrations of chlorine or chlorine related products. Do not overtighten plastic nuts.

IMPORTANT: DO NOT use plumber's putty to seal this fitting.

Fluidmaster UK
Twyford Road
Rotherwas, Hereford, HR2 6JR
Tel: 01432 357331
Fax: 01432 264014
E-MAIL: salesuk@fluidmaster.com
WEB: www.fluidmasterUK.com

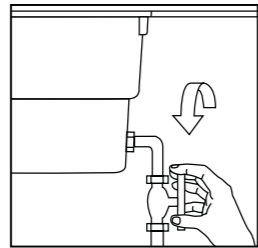

1. Turn off water supply to toilet cistern at storage tank in loft or isolator valve if mains fed.

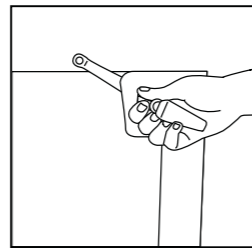

2. Unthread and remove old cistern lever.

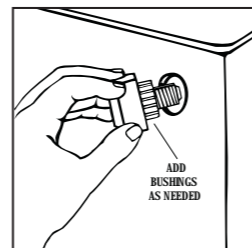

3. Slide push button shank through cistern hole (flat groove on threads facing up). For cistern with oversized mounting hole, use one, two or all three bushings for a snug fit. Start with the smallest bushing, medium, then largest bushing.

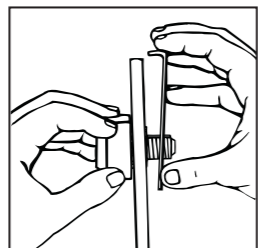

4. Place cistern mounting bracket over the threaded shank inside the cistern, allowing top of bracket to wrap over top of cistern.

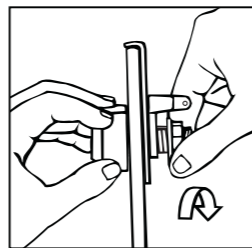

5. Position lever bracket onto threaded shank and secure with back nut. DO NOT OVERTIGHTEN.

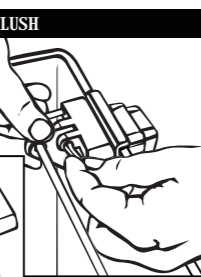

RIGHT FRONT MOUNT FLUSH
Slide pivot cam over brass lever arm.
Position lever arm/pivot cam onto lever bracket with the short leg of the lever arm located in the elongated hole in the lever bracket. Secure with cotter pin, spreading the pin tips apart with pliers to hold in place.

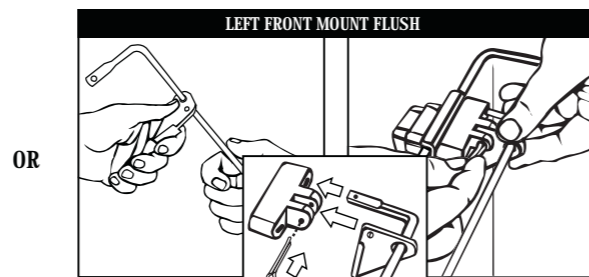

LEFT FRONT MOUNT FLUSH
Slide pivot cam over brass lever arm.
Position lever arm/pivot cam onto lever bracket with the short leg of the lever arm located in the elongated hole in the lever bracket. Secure with cotter pin, spreading the pin tips apart with pliers to hold in place.

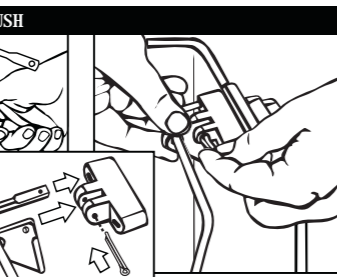

CORNER MOUNT FLUSH
Slide pivot cam over brass lever arm.
Position lever arm/pivot cam onto lever bracket and secure with cotter pin, spreading the pin tips apart with pliers to hold in place.

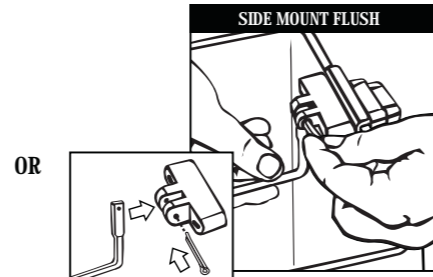

SIDE MOUNT FLUSH
Slide pivot cam over brass lever arm.
Position lever arm directly into lever bracket and secure with cotter pin, spreading the pin tips apart with pliers to hold in place. Note: No pivot cam needed.

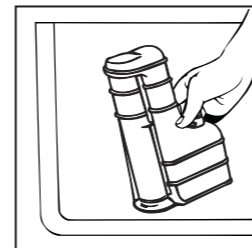

7. Disconnect pipe work and, if necessary, remove cistern from bowl. Remove old syphonic valve.

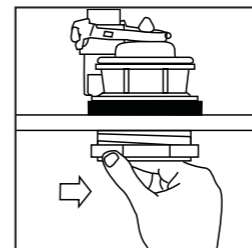

8. Slide new cistern seal onto threaded end of flush valve. Install new flush valve. Tighten back nut 1/2 turn beyond hand tight. DO NOT OVERTIGHTEN or cistern may crack.

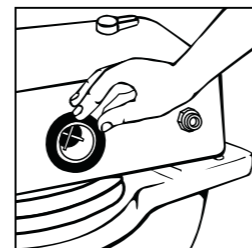

9. Carefully refit cistern-to-bowl seal (not supplied) onto threaded end of flush valve.

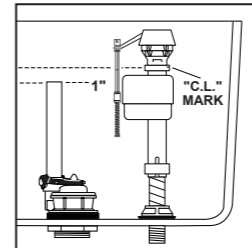

10. When installed, the top of the overflow pipe on the new flush valve should be at least 25mm (1 inch) below the hole in the cistern where the cistern lever is mounted. If necessary, cut the overflow pipe to achieve this height. The critical level mark on the float valve (identified by a C.L. mark on the Fluidmaster Float Valve) should be at least 25mm (1 inch) above the top of the overflow pipe.

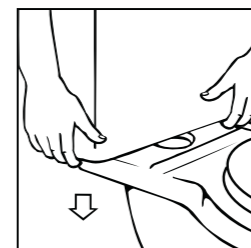

11. Reconnect cistern to pipe work or bowl.

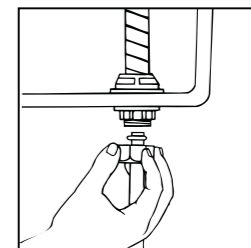

12. When position is correct and before tightening back nut of float valve, reconnect water supply to valve, making sure fibre washer is seated correctly. Tighten tap connector 1/4 turn past hand tight with spanner (DO NOT OVERTIGHTEN). Now tighten back nut with spanner 1/4 turn past hand tight (DO NOT OVERTIGHTEN).

CAUTION: Overtightening of back nut or tap connector could result in breakage and potential flooding.

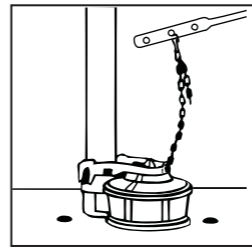

13. Attach flapper chain to middle hole in brass lever arm. Chain should have slight slack when flapper is in closed position. Cut excess chain. IMPORTANT: If chain is too tight, flapper will stay slightly open and leak. If the chain is too slack, it will not lift properly for a complete flush.

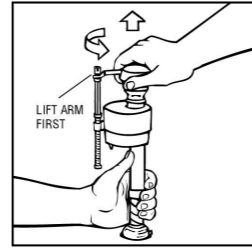

14. IMPORTANT: ALWAYS CLEAR DEBRIS FROM WATER LINE TO COMPLETE INSTALLATION. Before turning on water supply to cistern, remove VALVE TOP by lifting arm and rotating TOP 1/8 turn anti-clockwise, pressing down slightly on cap. While holding a container over the uncapped VALVE to prevent splashing, turn water supply on and off to clear debris that may be in supply line. Turn off water supply and replace TOP by engaging lugs and rotating 1/8 turn clockwise. MAKE CERTAIN TOP IS TURNED TO THE LOCKED POSITION. VALVE MAY NOT TURN ON IF TOP IS NOT FULLY TO THE LOCKED POSITION. Turn on water supply.

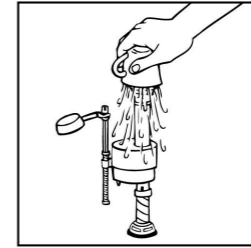

15. Adjust the water level by turning the water level adjustment rod and moving float cup up or down. Water level should be set to water line on cistern.

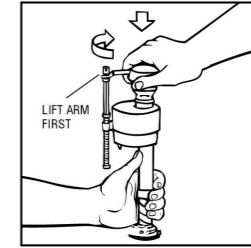

MINIMUM

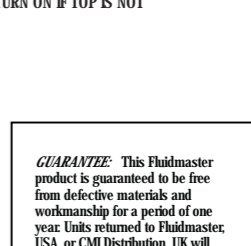

MAXIMUM

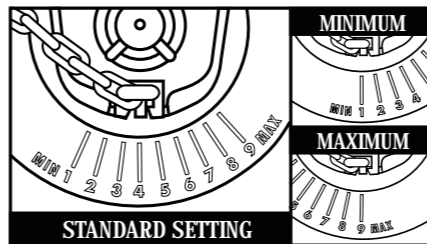

STANDARD SETTING
16. To adjust flush, begin where the chain attaches to frame as your center point. Flapper is set at "9" for maximum flush volume. For standard flush volume, rotate flapper to "4". For less (minimum) flush, rotate flapper to "1." Or, rotate anywhere in between for the desired flush volume.

GUARANTEE: This Fluidmaster product is guaranteed to be free from defective materials and workmanship for a period of one year. Units returned to Fluidmaster, USA, or CMI Distribution, UK will be replaced without charge.

Always use quality Fluidmaster repairparts when maintaining your Fluidmaster products. Fluidmaster shall not be responsible or liable for any damages caused by products used in Fluidmaster valves that were not manufactured by Fluidmaster, Inc.

MADE IN U.S.A. PATENT NUMBERS
U.S.-244683, 245172, 342896, 342933, 345580, 366913, 408098, 410092, 432794, 441630;
AUSTRALIA-421225, 423785, 427099, 433341,
489821, 587088; BELGIUM-699955, 780268; BRA-
ZIL-981533; CANADA-834406, 834517, 842557,
842538, 842559, 842560, 849302, 857002, 925398,
1046892, 1065731, 1065732, 1065733, 1065734,
1130509; COLOMBIA-199119; GERMANY-2132831,
GREAT BRITAIN-1298646, 1528291; HONG KONG-
857; ITALY-807405, 935451; JAPAN-810259,
1039796, 1108738, 543981, 578536; MEXICO-
129183, 1444009, 145652; NETHERLANDS-141630,
144013, 162449; SINGAPORE-270-1973; SOUTH
AFRICA-72-8273, 72-8734; SPAIN-342777, 393324;
SWEDEN-346348, 372594; SWITZERLAND-545389,
612471; TAIWAN-6937, 7168, 10051, 10077, UM-
41880. Other U.S. and Foreign patents pending.