

Maintenance and cleaning

The Torbeck valve is fitted with a filter which may need cleaning occasionally to ensure that optimum water-flow is maintained.

The procedure for cleaning the valve is as follows:

- 1 Turn off water.
- 2 Disconnect water supply from threaded tail.
- 3 Remove the filter / restrictor from threaded tail.
- 4 Clean the filter / restrictor by washing in water and ensure all grit and debris is removed.
- 5 Re-insert the filter / restrictor into tail and re-connect water supply.
- 6 Turn on water.

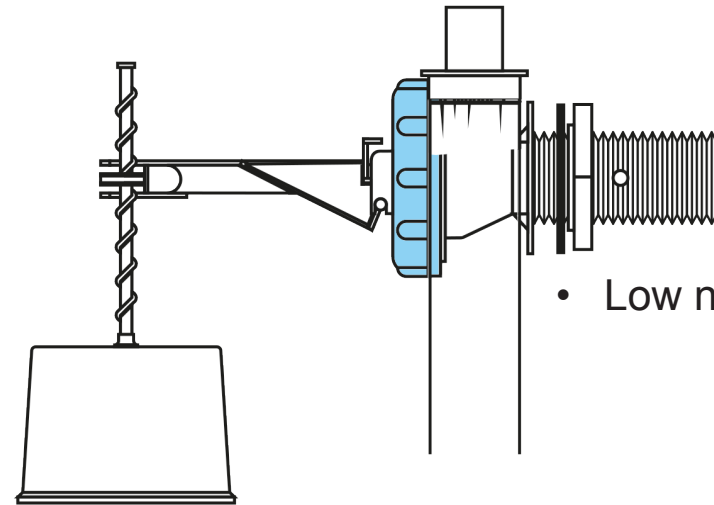
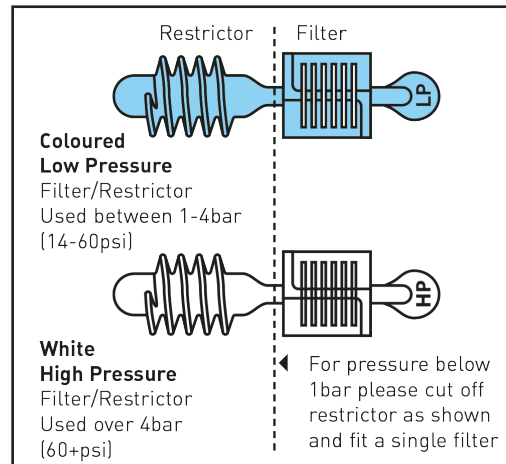
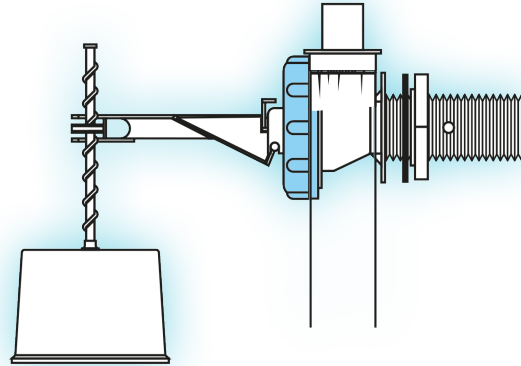

Side entry filling valve

- Low noise for quiet and efficient fill
- Reduces water hammer
- Neat and compact
- Easy to install
- Made in the UK



STAGE 1

Pre-installation

- 1 Turn off water supply to cistern and remove cistern lid.
- 2 While still full, mark the normal water level on the inside of the cistern.
- 3 Flush the cistern and remove all remaining water with a sponge or cloth. Ensure all dirt and loose particles are removed as they will impair the flushing valve operation.
- 4 Disconnect and remove existing filling valve.

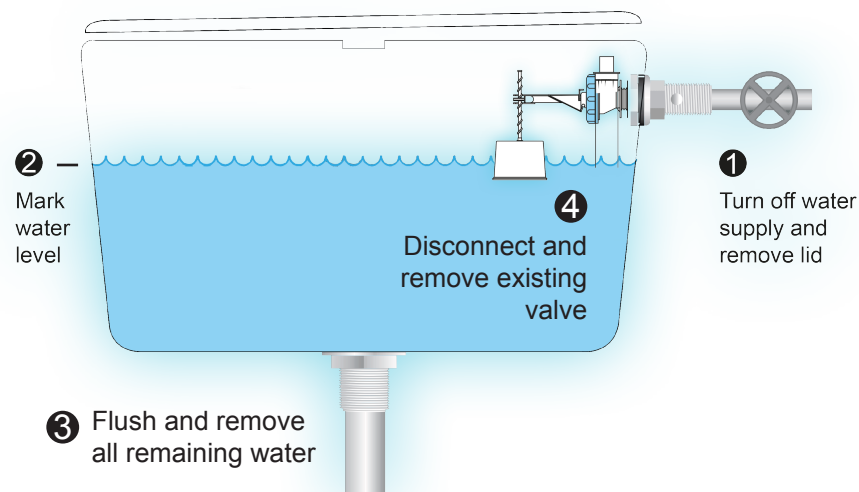

STAGE 2

Fitting your Torbeck filling valve

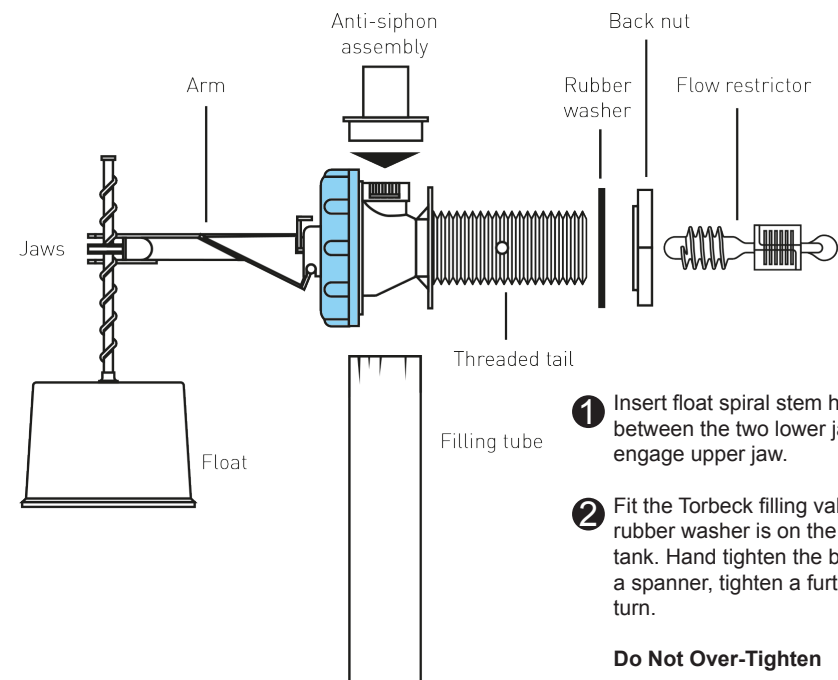

- 3 Insert correct flow combined filter restrictor into threaded tail - See overleaf for correct flow restrictor selection.
- 4 Fit anti-siphon securely by pushing firmly into position, ensuring clips are fully engaged over mating parts. Check the filler tube hangs down freely.
- 5 Re-connect water supply. Allow the cistern or tank to fill. Adjust water level by twisting the float up or down

Procedure for anti-siphon rotation

To rotate, place fingers over lugs and apply pressure to release anti-siphon assembly. Re-position and push firmly back into place ensuring clips are fully engaged over mating parts and filler tube hangs down freely.

Important for new-build installations

Before turning water on, ensure that one cold water tap is open so that dirt and loose particles in the pipe work are flushed through the tap.