

LOW RESOLUTION PDF DO NOT PRINT!

PART# 25-1329 Grev 4 09/17

FLUIDMASTER® 580AU CABLE DUAL FLUSH VALVE INSTALLATION INSTRUCTIONS FOR TOILET CISTERN



IMPORTANT: Prior to installation, turn the water off at the wall, flush toilet cistern and mop up the residual water to avoid spillage before removing the old outlet valve. After removing the old outlet valve, please clean the cistern tank of all dirt and grime, and ensure no debris is left in the tank.

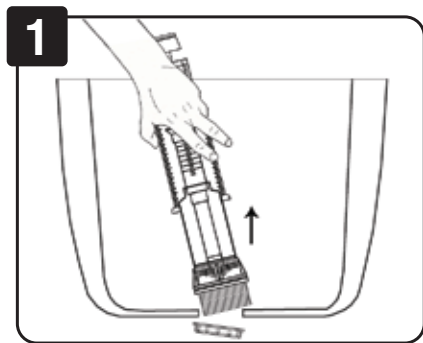

After turning the water off, remove the old fitting by removing the locking nut under the toilet tank.

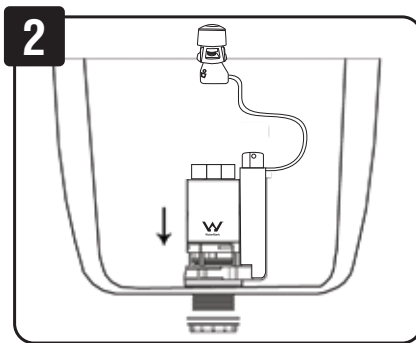

Once the old fitting is removed and the tank has been cleaned, insert the Fluidmaster outlet valve into position. **Note: Position cable opposite to inlet fill valve and ensure cable does not interfere with any moving parts within toilet cistern.**

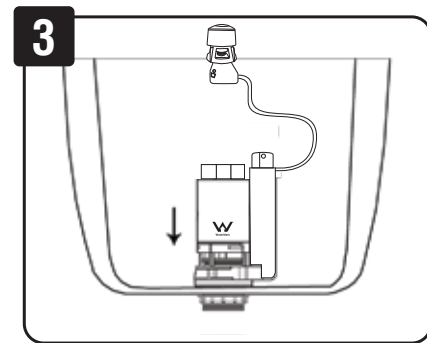

Ensure the rubber gasket is on the inside of the cistern tank. Holding outlet valve in place, thread large plastic locknut onto threads of outlet valve. Hand-tighten locknut and use large adjustable pliers to go 1/2 turn beyond hand tight. **DO NOT OVERTIGHTEN.**

IMPORTANT: DO NOT USE PLUMBER'S PUTTY TO SEAL THIS CABLE DUAL FLUSH VALVE

4 Select from the following 5 applications the correct mounting method for your toilet cistern and follow the instructions

Button Part Descriptions	Application A: Top Push Button 38mm	Application B: Top Push Button 48mm	Application C: Side Push Button	Application D: Front Push Button	Application E: 16-25mm Hole
<ul style="list-style-type: none"> Button Collar Button Outer Flange Big Nut Small Nut 	<ul style="list-style-type: none"> Button Big Nut <p>REMOVE & DISCARD</p> <ul style="list-style-type: none"> Button Collar Outer Flange Small Nut 	<ul style="list-style-type: none"> Button Big Nut Outer Flange <p>REMOVE & DISCARD</p> <ul style="list-style-type: none"> Button Collar Small Nut 	<ul style="list-style-type: none"> Button Button Collar Small Nut <p>REMOVE & DISCARD</p> <ul style="list-style-type: none"> Big Nut Outer Flange 	<ul style="list-style-type: none"> Button Button Collar Small Nut <p>REMOVE & DISCARD</p> <ul style="list-style-type: none"> Big Nut Outer Flange 	<ul style="list-style-type: none"> Button Collar Button Lock Small Nut <p>REMOVE & DISCARD</p> <ul style="list-style-type: none"> Big Nut Outer Flange

4B. Ensure the cable runs smoothly & does not interfere with the workings of the valve.

4C. Slide button lock in; secure button box to button & release to lock.

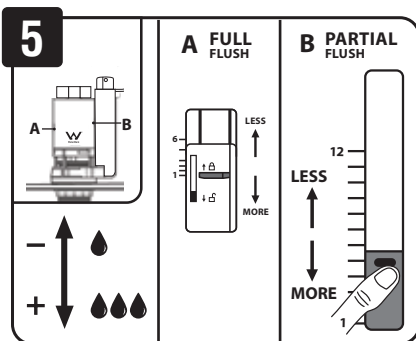
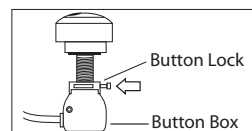

A. To adjust **FULL VOLUME**, first slide small tab to the unlock position. Push larger tab upwards for less water and downwards for more water.

B. To adjust **PARTIAL VOLUME**, push tab inwards while sliding tab upwards for less water and downwards for more water.

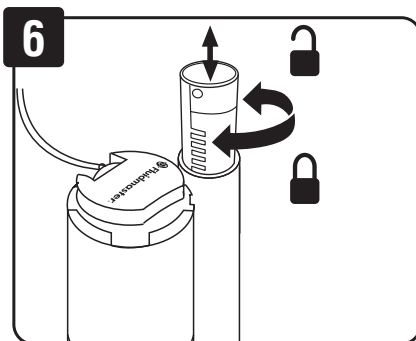

The over flow tube height can be adjusted up and down. Turn the over flow tube to the right to unlock. Adjust height to suit and turn the over flow tube to the left to lock. Ensure top of overflow is 25mm below the CL (Critical Level) line on the inlet valve. This is to ensure the correct air gap.

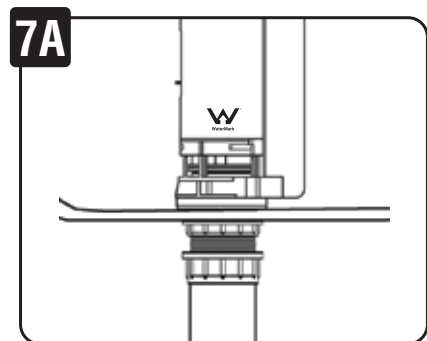

Wall Mount Cisterns: Connect the existing flush pipe to the base of the outlet valve and hand tighten the nut (Do not overtighten). Ensure the flush pipe nut washer is in good condition.

LOW RESOLUTION PDF DO NOT PRINT!

PART# 25-1329 Grev 4 09/17

FLUIDMASTER® 580AU CABLE DUAL FLUSH VALVE INSTALLATION INSTRUCTIONS FOR TOILET CISTERN

Fluidmaster 580AU Cable Dual Flush Valve Suits Flush Volumes:

4.5 Litre / 3 Litre

6 Litre / 3 Litre

9 Litre / 4.5 Litre

Please retain instructions for future reference.

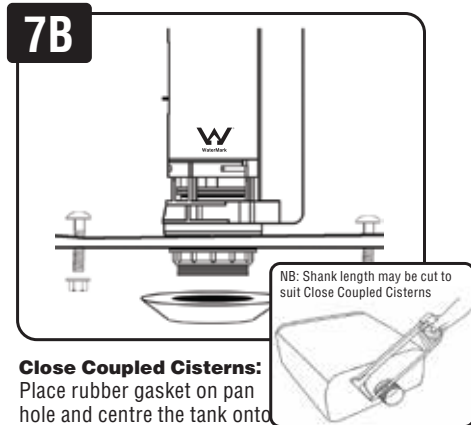

Close Coupled Cisterns:

Place rubber gasket on pan hole and centre the tank onto the washer. Where required, place bolts downwards in bolt holes and tighten.

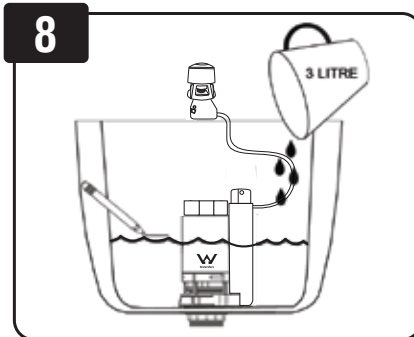

To establish water levels, pour in 3 litres of water, then press full flush. This will establish the residual water level mark, then add 3 litres on top of the residual water and mark the top of the water level. This is your 3 litre volume. Adjust half flush tab on the side to flush 3 litres.

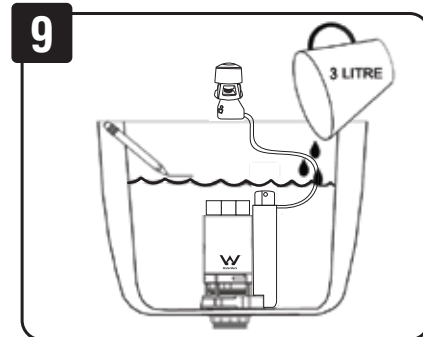

Fill tank with additional 3 litres (6 Litre total), for 6/3L Flush or Fill Tank with additional 1 1/2 litres (4.5 Litre total) for 4.5/3L Flush then mark the top of Water Level. This is your Full Flush, adjust the Full Flush Tab to set this volume.

(For older 9/4.5L flush toilet cisterns, use 4.5L to set half flush mark and add 4.5L on top of half flush volume to achieve 9L full flush volume mark)

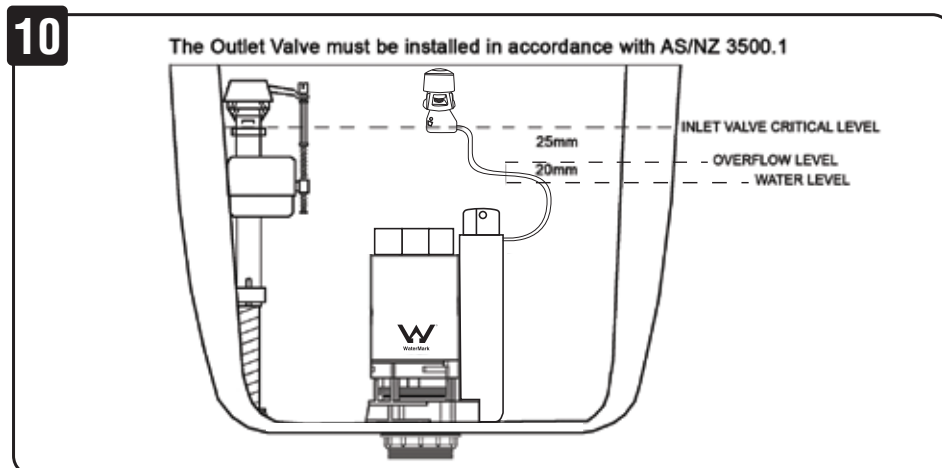

Maximum water level within the cistern tank must be no higher than 20mm below the top of the outlet valve overflow tube. The overflow tube may be raised or lowered depending on the maximum required level of water for a full flush, however the overflow height must always be 25mm below the critical level (CL) marked on the Inlet Valve to ensure an Air Gap. **Note: Position cable opposite to inlet fill valve and ensure cable does not interfere with any moving parts within toilet cistern. TURN ON WATER SUPPLY.**

OTHER REPLACEMENT PARTS AVAILABLE SEPARATELY



Tank to Bowl Gasket (Rubber)
For Close Coupled Only
Part # 6100



Tank to Bowl Gasket (Foam)
For Close Coupled Only
Part # 56-04



Flush Pipe
Locking Collar
Part # 56-03



Wedge Flush Pipe
Washer
Part # 56-02



Replacement Silicone
Outlet Washer
Part # 56-01

IMPORTANT: DO NOT USE PLUMBER'S PUTTY TO SEAL THIS CABLE DUAL FLUSH VALVE



Fluidmaster Holding Australia Pty Ltd

5B/100 New Street
Ringwood, Victoria 3134
Australia

Phone: +61 (03) 8870 2555

Toll Free: 1 800 931 166

Email: salesau@fluidmaster.com

Website: www.Fluidmaster.com.au

WARRANTY - Our goods come with guarantees that cannot be excluded under the Australian Consumer Law. You are entitled to a replacement or refund for a major failure and for compensation for any other reasonably foreseeable loss or damage. You are also entitled to have the goods repaired or replaced if the goods fail to be of acceptable quality and the failure does not amount to a major failure.

To present claims under this warranty, please contact your place of purchase or contact Fluidmaster Holding Australia Pty Ltd.

Warranty period is two years from date of purchase. Warranty excludes incorrect installation. Warranty on Replaceable Silicone Outlet Washer is subject to water conditions and fair wear and tear.

IN NEW ZEALAND Call 09 415 5585

WARNING



DO NOT USE IN-CISTERN DROP-IN TOILET BOWL CLEANERS CONTAINING BLEACH OR CHLORINE. Use of such products will: (1) RESULT IN DAMAGE to Cistern components and MAY CAUSE FLOODING and PROPERTY DAMAGE and (2) VOID FLUIDMASTER WARRANTY.
DO NOT overtighten nuts or cistern/bowl may crack. Always use quality Fluidmaster parts when installing or repairing. Fluidmaster will not be responsible or liable for use of non-Fluidmaster parts during installation or repair.