

# INSTALL WITH CONFIDENCE 7118E-022

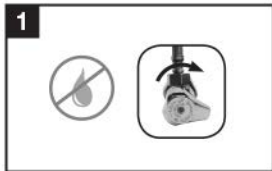

Turn off water to cistern. Flush cistern; hold down flush button to completely drain cistern tank. Remove any excess water at bottom of tank with a sponge. Unscrew old stop plug locknut and remove plug.



Install new cistern stop plug w/ pre-installed washer through cistern tank on opposite side of inlet valve. Hand-tighten new stop plug locknut and secure plug to cistern. **DO NOT OVERTIGHTEN.**

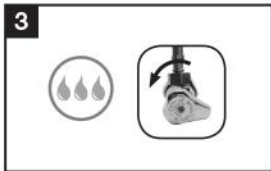

Turn on water supply to cistern and inspect for leaks.

## WARRANTY

Our goods come with guarantees that cannot be excluded under the Australian Consumer Law. You are entitled to a replacement or refund for a major failure and for compensation for any other reasonably foreseeable loss or damage. You are also entitled to have the goods repaired or replaced if the goods fail to be of acceptable quality and the failure does not amount to a major failure.

To present claims under this warranty, please contact your place of purchase or contact Fluidmaster Australia Holdings Pty Ltd. Note: Original proof of purchase required.

Warranty excludes incorrect installation. Installation shall be in accordance with AS/NZS 3500.1 and AS/NZS 3500.2 (Install with licensed plumber; any installation processed without licensed plumber will void warranty)

Only clean with soap and warm water to maintain quality finish. Do not use harsh chemical cleaners.



30800 Rancho Viejo Rd.,  
San Juan Capistrano, CA 92675  
[www.fluidmaster.com](http://www.fluidmaster.com)

Red/Green color arrangement is a registered trademark of Fluidmaster, Inc.  
© 2020 Fluidmaster, Inc. © Registered trademark of Fluidmaster, Inc.