

INSTALL WITH CONFIDENCE

7118E-023

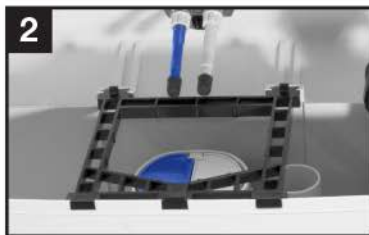





1
Install button onto lid with locknut and the 2 button rods onto button as shown.

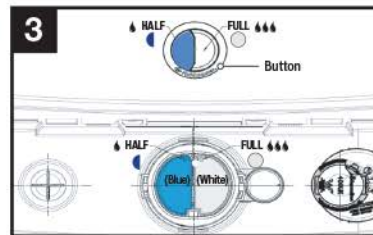

2
Ensure proper full and half flush alignment. *Align button rod and flush valve paddle colors.



3
Final button position as shown. Lock lid into place on the cistern tank.

*NOTE:  (Blue) = Half Flush 
 (White) = Full Flush 

WARRANTY

Our goods come with guarantees that cannot be excluded under the Australian Consumer Law. You are entitled to a replacement or refund for a major failure and for compensation for any other reasonably foreseeable loss or damage. You are also entitled to have the goods repaired or replaced if the goods fail to be of acceptable quality and the failure does not amount to a major failure.

To present claims under this warranty, please contact your place of purchase or contact Fluidmaster Australia Holdings Pty Ltd. Note: Original proof of purchase required.

Warranty excludes incorrect installation. Installation shall be in accordance with AS/NZS 3500.1 and AS/NZS 3500.2 (Install with licensed plumber; any installation processed without licensed plumber will void warranty)

Only clean with soap and warm water to maintain quality finish. Do not use harsh chemical cleaners.



30800 Rancho Viejo Rd., San Juan Capistrano, CA 92675 | www.fluidmaster.com

Red/Green color arrangement is a registered trademark of Fluidmaster, Inc.
© 2020 Fluidmaster, Inc. © Registered trademark of Fluidmaster, Inc.